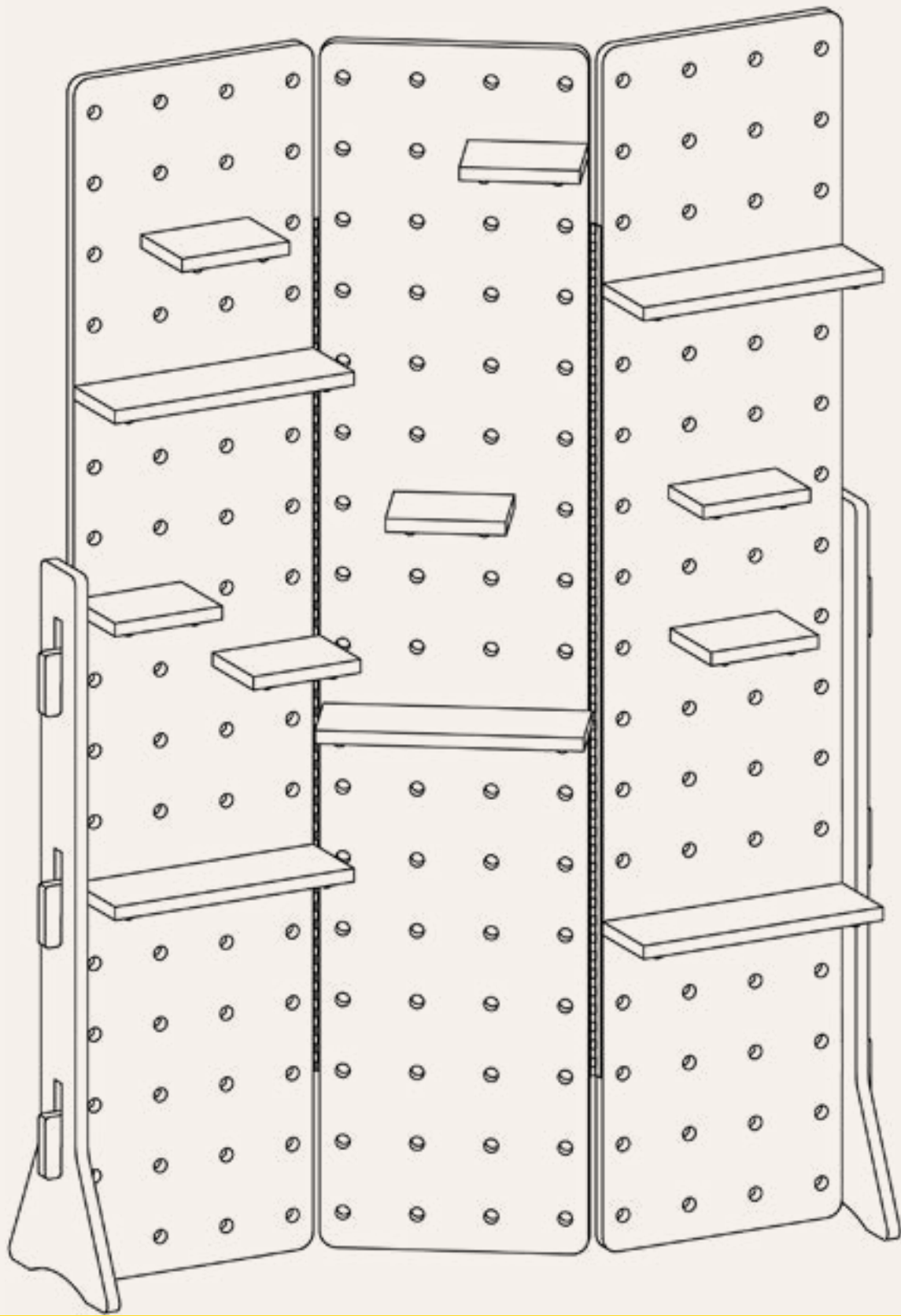


DOWEL COLLECTION



SKU: DBRDPBTL

LARGE FOLDING PEG BOARD USER GUIDE

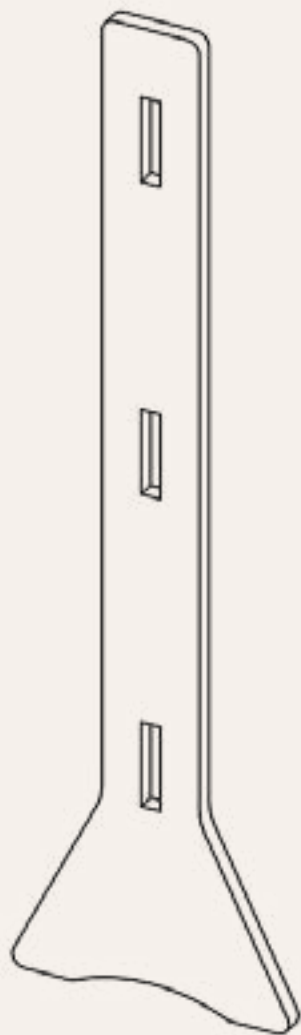
DANDELION

RESPONSIBLY CREATING BETTER PRODUCTS FOR A BETTER WORLD

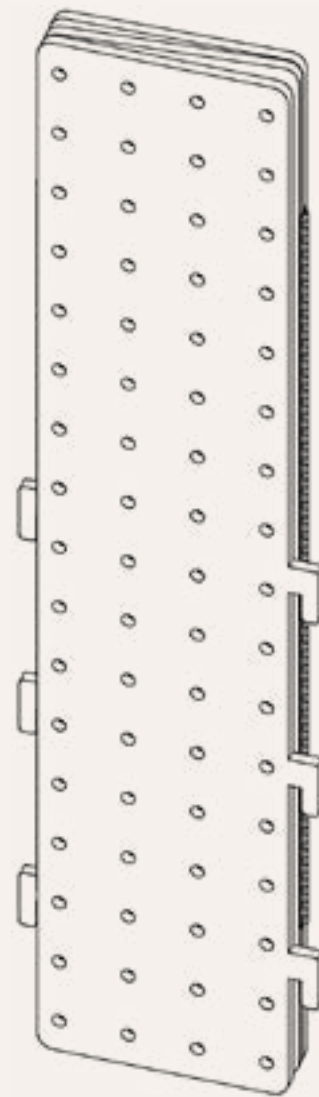


Table of Contents

USER GUIDE



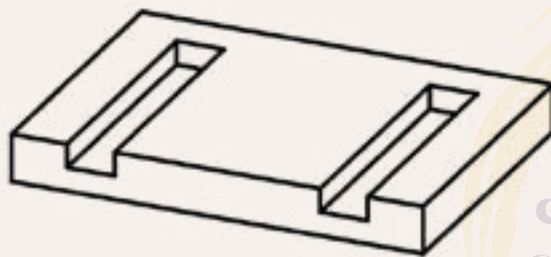
A. Legs x2



B. Peg Board x1



C. Dowels x60



D. Small Shelf x7

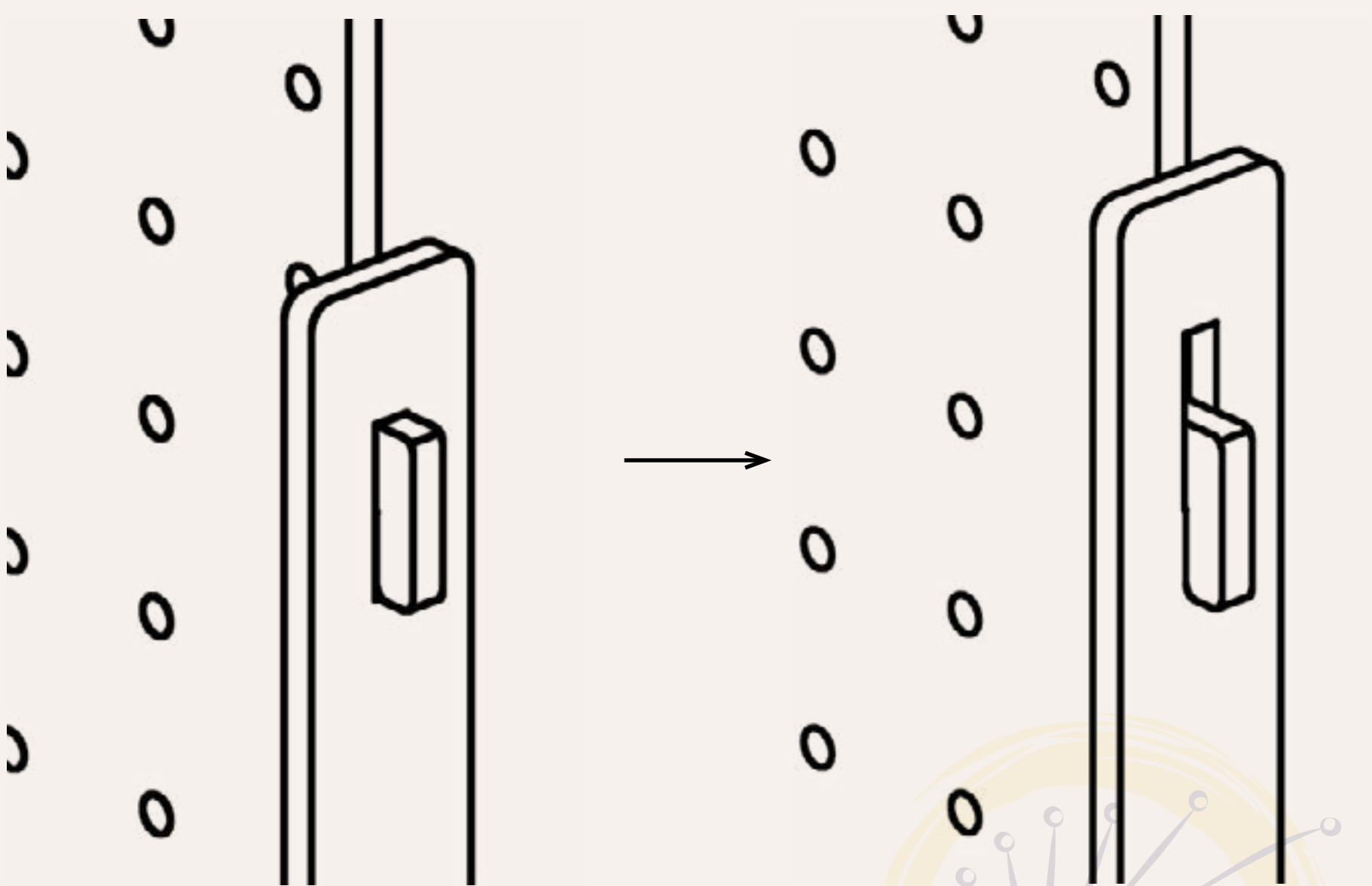


F. Rubber Feet x4



E. Medium Shelf x5

PARTS DIAGRAM



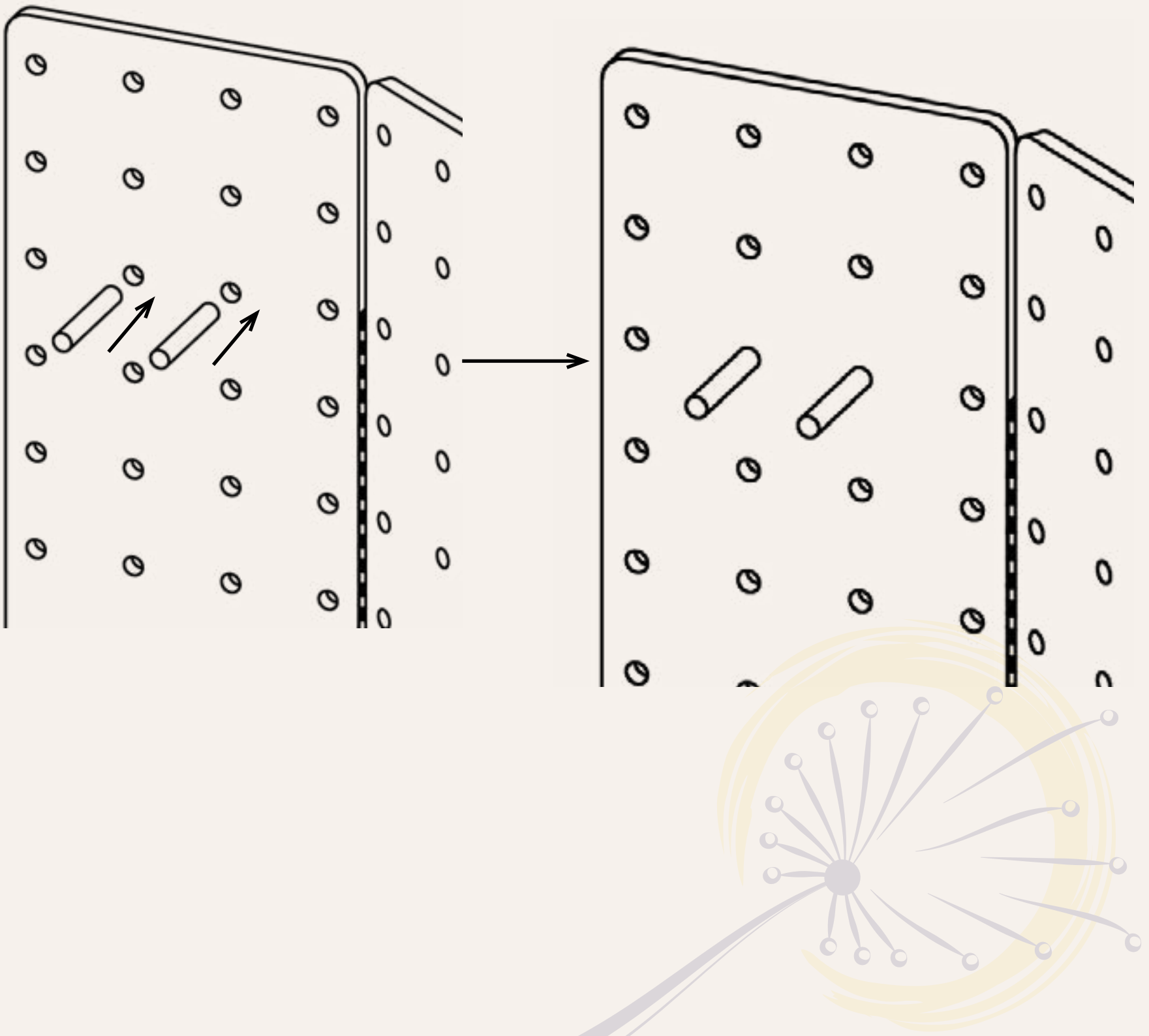
1. Stand up peg board.

TWO PEOPLE are required for the next two steps.

2. As one person lifts the unit, the other should fit the leg over the notches on the peg board. Then, press legs up to lock in place.

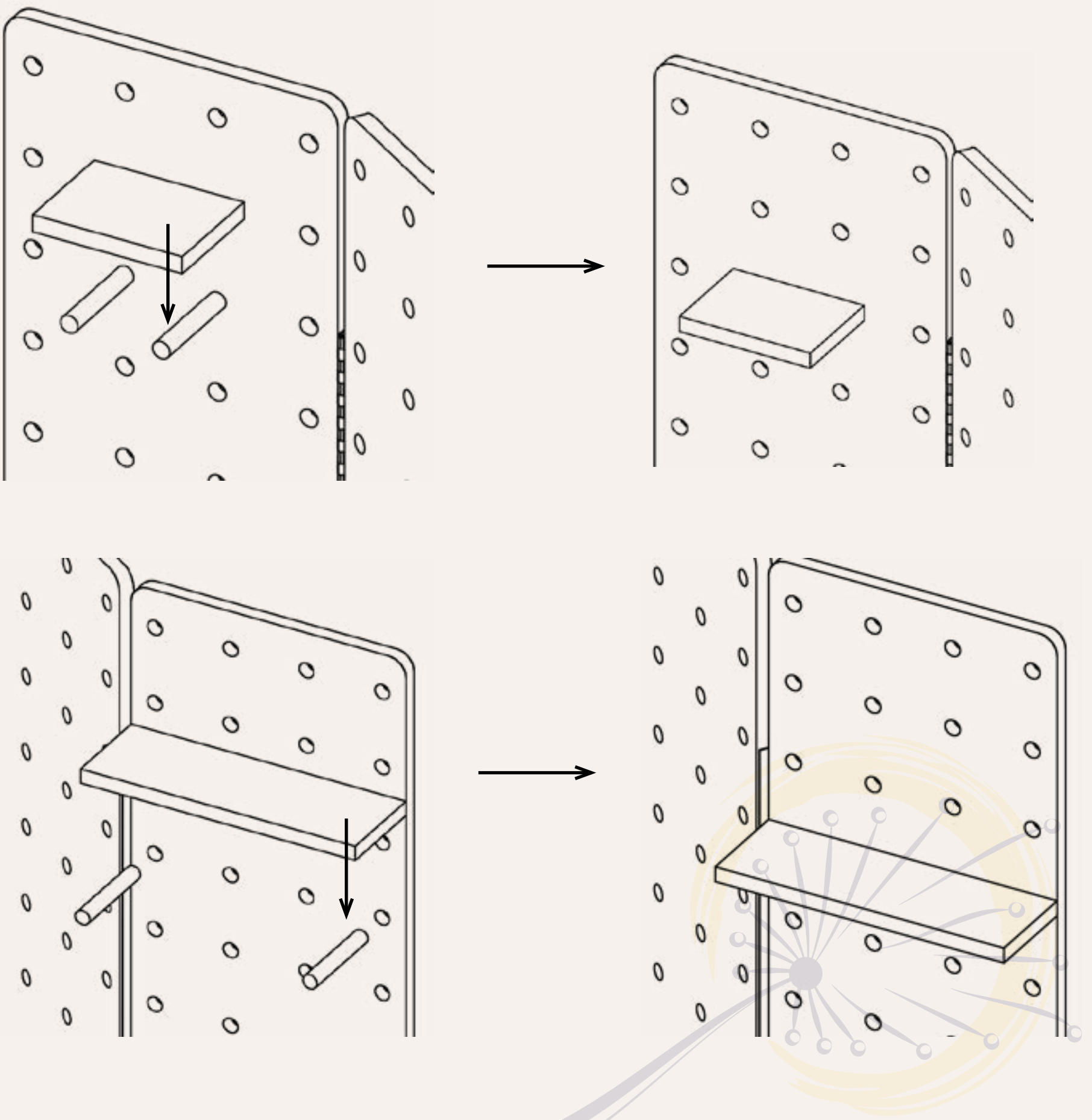
3. Repeat on opposite side, as shown.

ASSEMBLY INSTRUCTIONS



4. Insert dowels into the pegboard at desired height(s).

ASSEMBLY INSTRUCTIONS



5. Press shelves down onto the dowels.
6. Repeat for as many shelves as desired.

ASSEMBLY INSTRUCTIONS

THANK YOU FOR SPREADING
THE SEEDS OF SUSTAINABILITY
AND HELPING TO PROTECT
OUR PLANET.



HAVE A QUESTION? GET IN TOUCH WITH
OUR DANDELION REPRESENTATIVES AT:
888-257-6639

CONTACT US